

Courtesy Of Henry Han Of Century 21 Masters

## \$152,000 - 235 4404 122 Street, Edmonton

MLS® #E4447485

**\$152,000**

3 Bedroom, 2.00 Bathroom, 1,383 sqft  
Condo / Townhouse on 0.00 Acres

Aspen Gardens, Edmonton, AB

This outstanding second-floor unit features 1383 sq. ft., 3 bedrooms, 2 baths, in-suite laundry and 1 assigned parking stalls. Condo fee includes electricity, water, and heat. A bright open kitchen boasts countertops and loads of cupboard space. An entertaining-sized living room with lots of windows and patio doors to a good-sized northeast-facing balcony. The primary suite features a 4-piece ensuite, while the 4-piece main bathroom is conveniently located just outside the two additional bedrooms. This building offers fantastic amenities, including a fitness center and a party room. Designated schools are Westbrook School (K6) and Vernon Barford School (7-9). Providing easy access to Whitemud Ravine, Snow Valley Ski Hill, major roadways, and public transportation.

Built in 1976

### Essential Information

MLS® #	E4447485
Price	\$152,000
Bedrooms	3
Bathrooms	2.00
Full Baths	2
Square Footage	1,383
Acres	0.00
Year Built	1976

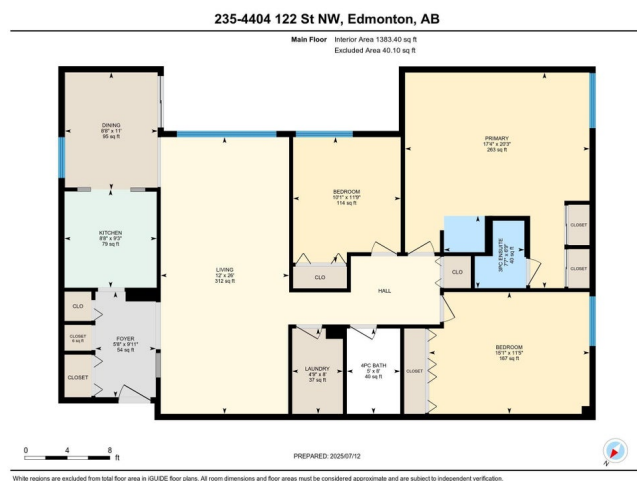

Type	Condo / Townhouse
Sub-Type	Lowrise Apartment
Style	Single Level Apartment
Status	Active

### Community Information

Address	235 4404 122 Street
Area	Edmonton
Subdivision	Aspen Gardens
City	Edmonton
County	ALBERTA
Province	AB
Postal Code	T6J 4A9

### Amenities

Amenities	Exercise Room, Intercom, Parking-Visitor, Party Room, Pool-Indoor, Recreation Room/Centre, Secured Parking, Security Door, Television Connection
Parking Spaces	1
Parking	Single Carport
Has Pool	Yes

### Interior

Interior Features	ensuite bathroom
Appliances	Dishwasher-Built-In, Microwave Hood Fan, Refrigerator, Stacked Washer/Dryer, Stove-Electric, Window Coverings
Heating	Hot Water, Natural Gas
# of Stories	4
Stories	1
Has Basement	Yes
Basement	None, No Basement

### Exterior

Exterior	Wood, Brick, Vinyl
Exterior Features	Fenced, Golf Nearby, Landscaped, Paved Lane, Picnic Area, Playground Nearby, Public Transportation, Schools, Shopping Nearby, Ski Hill Nearby
Roof	Asphalt Shingles
Construction	Wood, Brick, Vinyl
Foundation	Concrete Perimeter

**Additional Information**

Date Listed	July 12th, 2025
Days on Market	6
Zoning	Zone 16
Condo Fee	\$1,000

DATA IS DEEMED RELIABLE BUT IS NOT GUARANTEED ACCURATE BY THE REALTORS® ASSOCIATION OF EDMONTON. COPYRIGHT 2025 BY THE REALTORS® ASSOCIATION OF EDMONTON. ALL RIGHTS RESERVED.Trademarks are owned or controlled by the Canadian Real Estate Association (CREA) and identify real estate professionals who are members of CREA (REALTOR®, REALTORS®) and/or the quality of services they provide (MLS®, Multiple Listing Service®)

Listing information last updated on July 18th, 2025 at 1:47am MDT